

TDC Power Products Co.,Ltd  
Cheng Yen Electronic Co.,Ltd

**DA-40-12W-1**

INPUT VOLTAGE **120VAC**  
OUTPUT VOLTAGE **12VAC**

**ELECTRICAL & MECHANICAL SPECIFICATION**



**E181950**

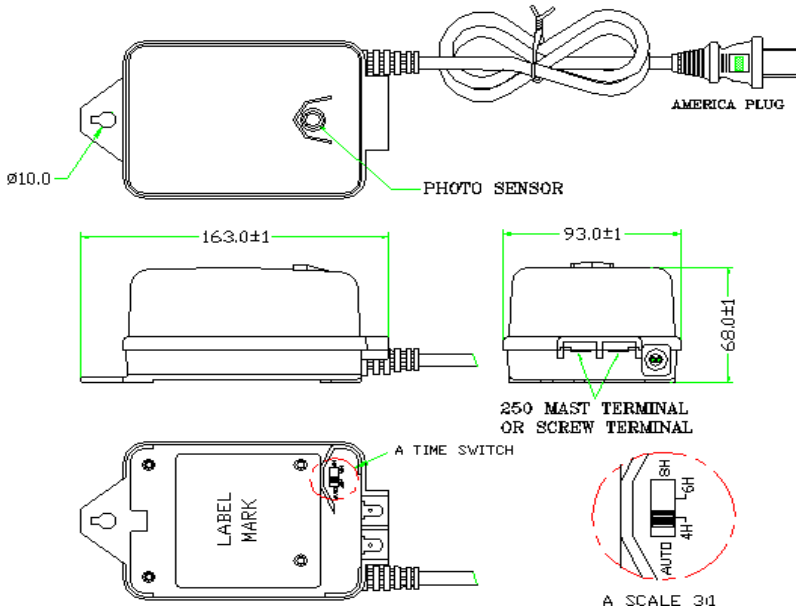

**ELECTRONICAL SPECIFICATION**

Input Voltage	<b>120</b>	Volts
Frequency (Hz)	<b>60</b>	Hz
Power Rated (W)	<b>48</b>	W
Exciting Current With No load	<b>60</b>	mA Max
Exciting Current With Full load	<b>400</b>	mA Max
Output Voltage	<b>12.0</b>	Volts±5%
Output Current	<b>3.33</b>	Amp±5%
Output Voltage Without Load	<b>13.2</b>	Volts±5%
Voltage Range at Rated (Output)	<b>11.4~12.6</b>	Volts
Current Range at Rated (Output)	<b>3.16~3.50</b>	Amp
HI-POT :		
Leakage Current	<b>0.5</b>	m A
Test Time	<b>1</b>	Min
PRI TO SEC	<b>1250</b>	Volts
PRI TO CORE	<b>1250</b>	Volts
SEC TO CORE	<b>1250</b>	Volts
Efficiency	<b>70</b>	%
Insulation Class	<b>B (130)</b>	°C

**PHOTO CELL & TIMER CONTROL**

AUTO: Photo cell Control "On".  
4H. 6H. 8H: Photo cell Control "On",  
Will "Off" Output Power Full Time.

**MECHANICAL SPECIFICATION**

Dimensions (L*W*H)	<b>163.0*93.0*68.0</b>	mm
Weight	<b>1020</b>	g
Environment:		
Operating Temperature	<b>-10 To 40</b>	°C
Storage Temperature	<b>-20 To 70</b>	°C
Relative Temperature 40°C±2°C		
<b>RELATIVE HUMIDITY</b>	<b>90% RH</b>	

**ELECTRICAL CIRCUIT**

