

TDC Power Products Co.,Ltd
Cheng Yen Electronic Co.,Ltd

DA-52-12W-1

INPUT VOLTAGE **120VAC**
OUTPUT VOLTAGE **12VAC**

ELECTRICAL & MECHANICAL SPECIFICATION



E181950

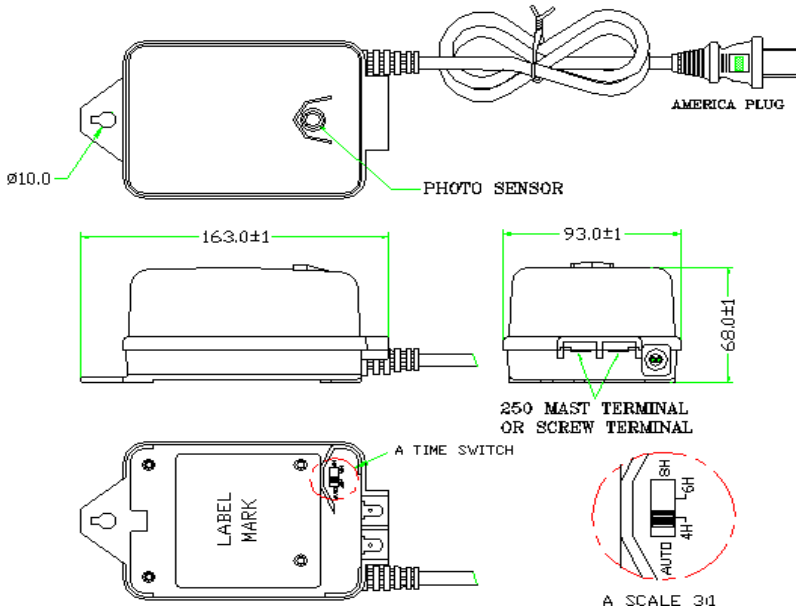

ELECTRONICAL SPECIFICATION

Input Voltage	120	Volts
Frequency (Hz)	60	Hz
Power Rated (W)	65	W
Exciting Current With No load	80	mA Max
Exciting Current With Full load	520	mA Max
Output Voltage	12.0	Volts
Output Current	4.33	Amp
Output Voltage Without Load	13.2	Volts
Voltage Range at Rated (Output)	11.4~12.6	Volts
Current Range at Rated (Output)	4.11~4.55	Amp
HI-POT :		
Leakage Current	0.5	m A
Test Time	1	Min
PRI TO SEC	1250	Volts
PRI TO CORE	1250	Volts
SEC TO CORE	1250	Volts
Efficiency	70	%
Insulation Class	B (130)	°C

PHOTO CELL & TIMER CONTROL

AUTO: Photo cell Control "On".
4H. 6H. 8H: Photo cell Control "On",
Will "Off" Output Power Full Time.

MECHANICAL SPECIFICATIONS

Dimensions (L*W*H)	163.0*93.0*68.0	mm
Weight	1425	g
Environment:		
Operating Temperature	-10 To 40	°C
Storage Temperature	-20 To 70	°C
Relative Temperature 40°C±2°C		
RELATIVE HUMIDITY	90% RH	

Input Cable: **SJTW 18AWG/2C 105 °C
2.0M LONG+AMERICA PLUG**
Output Cable: **250 MAST TERMINAL (2P)
OR SCREW TERMINAL (2P)**

ELECTRICAL CIRCUIT

